



# Grand Slam 380 Installation Instructions



Patent #7,114,283

Taco Metals, Inc., 50 NE 179 Street • Miami, Florida 33162  
info@tacomarine.com • tacomarine.com

# YOUR KIT CONTAINS

- 2- Grand Slam 380 mounts
- 8- 5/16" -18 x 1" stainless steel button head cap bolts (C)
- 8- Nylon flat washers (E)
- 2- Rotator Handles
- 8- Vinyl Tubing Spacer (B)
- 1- Instruction Booklet
- 1- Warranty Card

## INSTALLATION

### (USING A TACO MARINE PRE-DRILLED PLATES)

It is very important that your mounting surface for the "Grand Slam" (i.e., T-Top, Arch or Hard Top), be suitably constructed to provide a strong mounting area for your outrigger base. It is recommended to use Taco Marine's weld-in Grand Slam extrusions:



These plates are pre-drilled and ready to install the Grand Slam. If you already have a plate, it should be at least 3/8" thick and 5" wide, with 3-4 welded seams to be used for the full 6" bow to stern.

When installing the Grand Slam GS-380 through canvas, simply cut an X over the 3-1/8" hole. Install and bolt down the Grand Slam\*, then trim off the excess canvas.

When installing through a hardtop make sure the top is foam or core filled. It is recommended to use included spacers (small lengths of tubing cut to size) to fit inside where the mounting bolts pass through to ensure that when the bolts are tightened the top is not compressed.

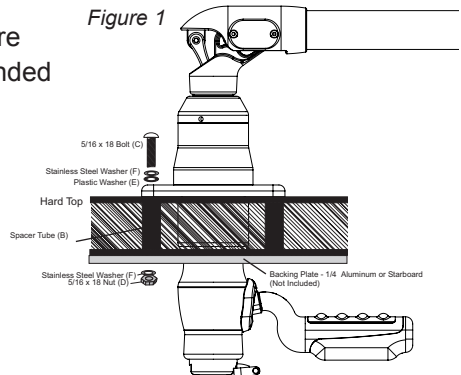



- Backing plates are available for extra strength and recommended when mounting through a hard top.
- When installing your Grand Slam locate the center of the 3-1/8" hole at least 9-1/2" from the hardtop frame, vertical post, or any other object that might hinder the movement of the handle.
- If the top has an arch to it, wedge plates can be ordered to keep the Grand Slams upright and straight.
- The maximum thickness allowable for GS-380 mounting is 2"



## INSTALLATION (USING A SOLID PLATE)

*If you are installing through a solid plate already on your boat please read the following instructions.*

1. Before drilling your bolt holes, cut out a 3-1/8" diameter center hole.
2. When you are finished drilling your 3-1/8" hole, set the base in the hole being careful not to scratch the anodized finish of the lower components, or to damage the white angle height position indicator.  
**Use your outriggers to help align the base.**
3. The supplied template is only a guide to help align base for true hole positioning. Make sure nothing is rubbing in the 3-1/8" hole. There should be a small gap all the way around.
4. When the Grand Slams are aligned, mark and drill out the bolt holes.
5. Bolts, washers and nuts are provided or if you purchase your own, always use good quality stainless steel hardware when mounting the base. Please do not attempt to weld the base to anything.
6. If using a backing plate, put a bead of marine sealant on the underside of the flat plate. This prevents water drips.

**Note: Always use a nylon 5/16" washer underneath any stainless steel washer to prevent corrosion of the Grand Slams anodized aluminum mounting base.**

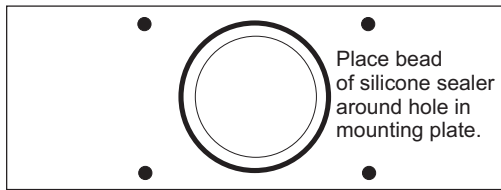
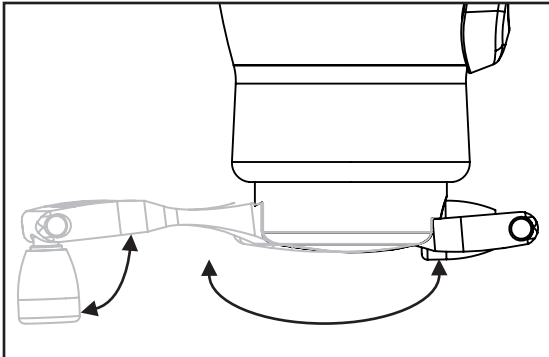
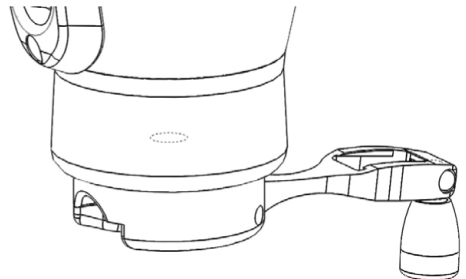
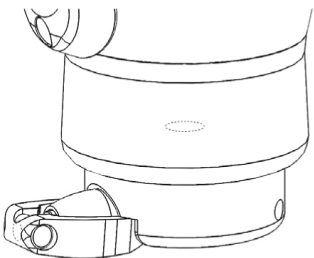

Figure 2

7. Securely bolt the base to the mounting surface\*. Install operating lever last. Insert lever from the larger open-ended slot, from stern facing position. (The bottom part of the Grand Slam can be rotated to locate this hole). Lubricate threads with oil or grease, make sure the handle is all the way in. Screw the handle adapter to the mount using the 4mm screws. Place the outrigger in the arm and test. Pull down on the lever and move port to starboard. Release the lever, and it should go into locking positions. There are 20 locking positions. If the lever does not return up, push left or right until it falls into position. Turn the crank handle to full up and down outrigger position to ensure the outrigger does not interfere with other top mounted accessories. The pull pin for the outrigger is spring loaded. Simply pull out the pull pin, rotate 1/4 turn and release. Place your outrigger into the arm and turn the pull pin to snap back into position. Then turn your outrigger until it clicks in the locked position with eyelets facing aft.



The GS-380 incorporates a dual folding crank. The Knob folds into the stainless steel arm, then the arm folds flush with rotator base.





*tacomarine.com is your “go to” place for tips & answers to questions about Taco Marine products.*

**Figure 3**

**Important Note:**  
**Apply removable Loctite (not supplied) #242 (Blue) to threads prior to assembly and final tightening. Tighten using a short 3/16" hex wrench.**

*Place a few drops of machine oil here to lubricate seals*

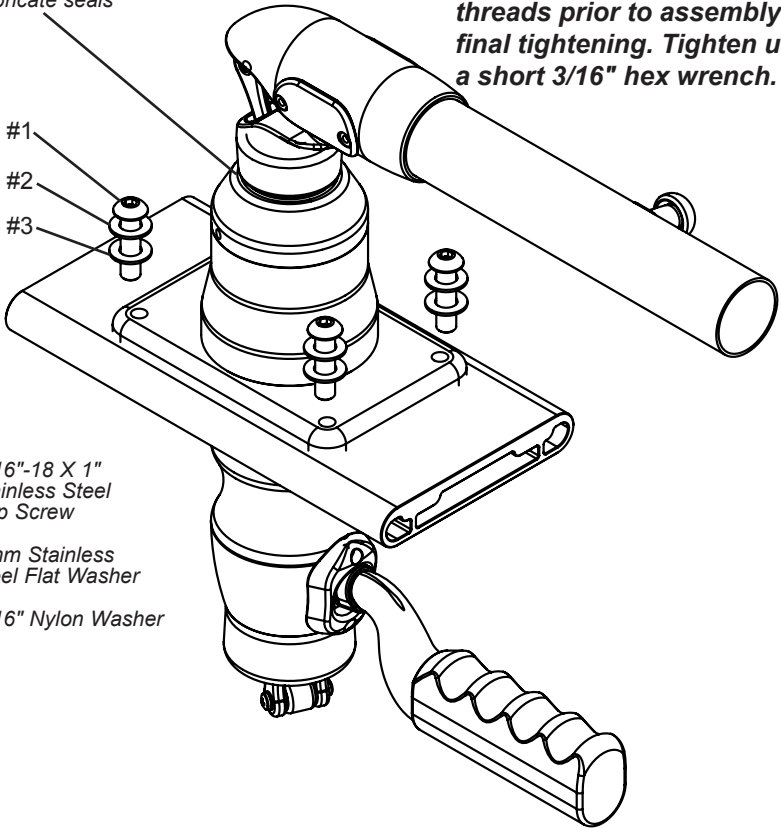

#1) 5/16"-18 X 1" Stainless Steel Cap Screw

#2) 8mm Stainless Steel Flat Washer

#3) 5/16" Nylon Washer

**Important Running Note:**

**When not trolling, always crank the Grand Slam 380 fully-clockwise (when viewed from underneath), back to the “run” position using the crank handle and retract outriggers.**

## HOW TO CLEAN

Always use a mild, non abrasive soap and lots of fresh water. Thoroughly wash the aluminum with a soft towel or sponge utilizing lots of soap and water to remove all dried salt crystals and other contaminants. Rinse completely with direct water pressure. The point is to clean and rinse it well! Use a small amount of machine oil, where the arm comes out of the base. This will keep the seals lubricated.

## SAFE CLEANERS

- Mild Dish washing Liquid
- Specialty Marine Cleaners:
  - Sea Safe Boat Wash
  - Boatwash Concentrate
  - Super Suds

## HARMFUL CLEANERS

- Bleach (Clorox, etc.)
- Mild Abrasive Cleaners (Ajax, Comet, Soft Scrub, Rubbing Compounds, etc.)
- Strong Cleaners (409, Engine Degreasers, etc.)

## WHAT IS TROLLING? HOW DO I USE MY OUTRIGGERS?

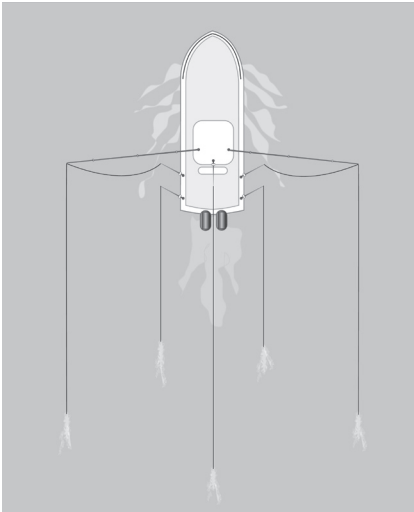

When trolling with outriggers, you can troll with more lines in the water, thus pulling more bait which simulates a school of fish. Outriggers will eliminate tangled lines, each outrigger can accommodate one or two lines from your rods and reels. The line is used with a release clip that extends to the end of your outrigger. When a fish strikes your bait, the release clip will allow your fishing line to come free of the outrigger so you can reel in the fish.

## **WARNING**

All outriggers (telescoping and fixed) in the extended position are susceptible to breakage while operating the boat at high speeds in rough conditions. TACO Tele-Outriggers are designed for increased durability to ensure a long and useful life. Nonetheless, it is recommended that certain precautions be taken to avoid unnecessary damage. Use good judgment in rough seas, it is recommended that you retract the outriggers before reaching high speeds resulting in “pounding” and “whipping” that can damage outriggers.

Excessive release clip tension or faulty clips can cause unnecessary loads on outriggers and mounts that result in failure. It is recommended that you check and adjust your clips before each use.

## **TACO TELE-OUTRIGGERS**

Patent #5,921,196



This patented design outrigger is the perfect compliment for your new Grand Slam. Available in black and silver, these poles retract to less than 6' for bridges, trailering and storage.



info@tacomarine.com  
tacomarine.com